

Swivel throttle check valve Series MV15MC23-C/V



Design type	Needle valve, Compression fitting ring piece
Material	Body Nickel-plated brass, Seals NBR and Polyamide (PA)
Function	Flow control in one direction, free flow in the opposite direction, Actuation with slotted screw
Connection	M5 after ISO R/262, G1/8" ... G3/8" after ISO228/1
Hose outside diameter	6mm, 8mm and 10mm
recommended materials	Polyamide (PA), Polyurethane (CP/PU), Polyethylene (PE), Polyamide - highly flexible (PF), PTFE (PT)
Hose tolerances	+/-0,05 mm up to diameter 10mm
Mounting position	any
Medium	Compressed air, neutral gases
Medium temperature	-20...+70°C
Operating pressure	0...10bar



Dimensions

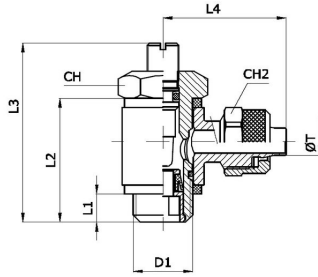

D1	Hose diameter ØT D/d [mm]	L1	L2	L3max.	L4	Throttle direction	CH	CH2	Weight [g]	Type
M5	6/4	4	16	23,5	19	from thread to hose (exhaust air)	8	9	12	MV15MC23-06-M5-C
G1/8"	6/4	5	24	32	25	from thread to hose (exhaust air)	14	12	36	MV15MC23-06-18-C
G1/4"	6/4	6,5	27,5	40	26,5	from thread to hose (exhaust air)	17	12	58	MV15MC23-06-14-C
G1/4"	8/6	6,5	27,5	40	27,5	from thread to hose (exhaust air)	17	14	60	MV15MC23-08-14-C
G3/8"	8/6	7	31	48	29,5	from thread to hose (exhaust air)	20	14	98	MV15MC23-08-38-C
G3/8"	10/8	7	31	48	30,5	from thread to hose (exhaust air)	20	16	100	MV15MC23-10-38-C
M5	6/4	4	16	23,5	19	from hose to thread (supply air)	8	9	12	MV15MC23-06-M5-V
G1/8"	6/4	5	24	32	25	from hose to thread (supply air)	14	12	36	MV15MC23-06-18-V
G1/4"	6/4	6,5	27,5	40	26,5	from hose to thread (supply air)	17	12	58	MV15MC23-06-14-V
G1/4"	8/6	6,5	27,5	40	27,5	from hose to thread (supply air)	17	14	60	MV15MC23-08-14-V
G3/8"	8/6	7	31	48	29,5	from hose to thread (supply air)	20	14	98	MV15MC23-08-38-V
G3/8"	10/8	7	31	48	30,5	from hose to thread (supply air)	20	16	100	MV15MC23-10-38-V

Flow diagram

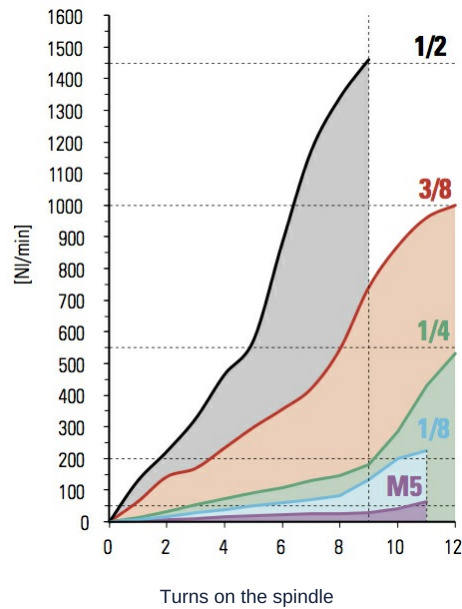

Illustrations non-binding

Design, dimensional and material changes reserved

Pneumatics / Flow control valves / Other materials - P04 / Unidirectional banjo flow control valve Series MV15MC23-C/V

Version 5

138407 / Generated 2026/24 EN

MADE IN EUROPE

+43 512 52076

austria@stasto.eu

© STASTO Automation KG

www.stasto.com

Open series online

Page 2 / 2

