

## Water trap tubes Series SI

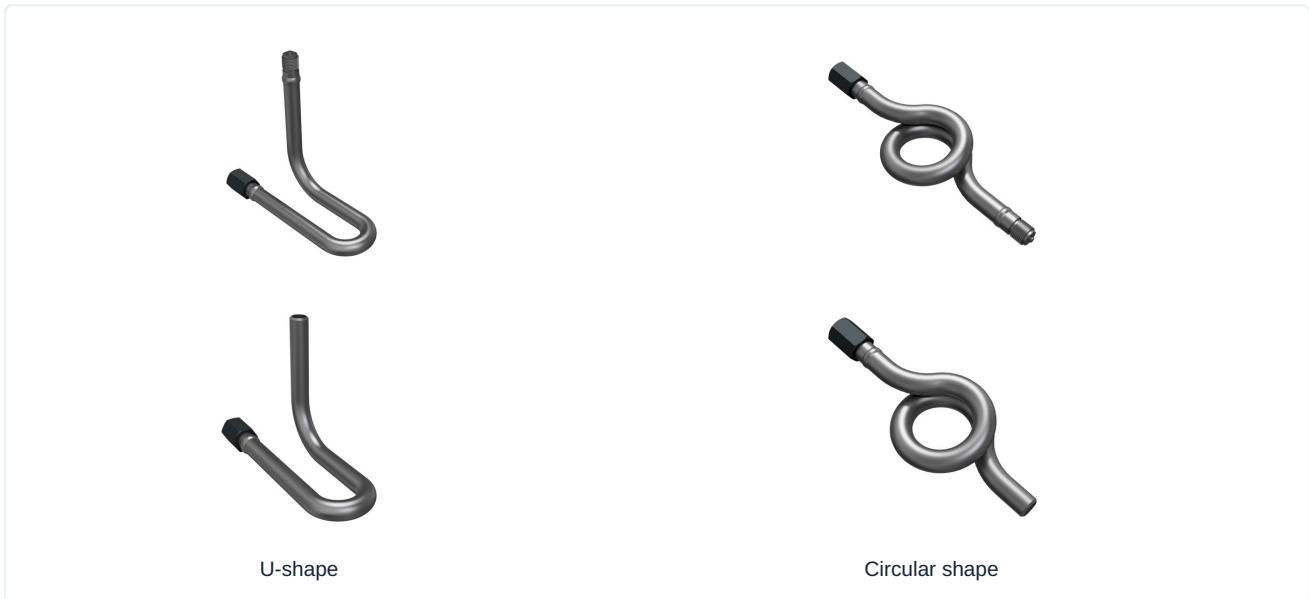

U-shape

Circular shape

Design type	Water trap tube U- and circular shape with clamping sleeve to DIN16283
Connection	Connection spigot or welding connection or rather G1/2"
Materials	Steel or Stainless steel 1.4571
Medium	Liquids, gases and vapours that do not attack the materials used.
Medium temperature	max. 400°C
Operating pressure	temperature-dependent: 160bar at 120°C, 120bar at 300°C, 100bar at 400°C
Pressure tapping	U-shape: horizontal only Circular shape: vertical only

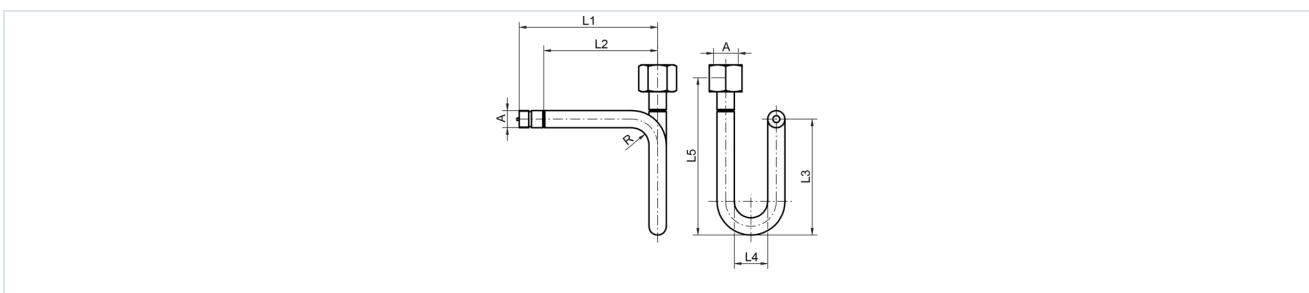

Connection	A	L1	L2	L3	L4	L5	Material	Standard	Weight [kg]	Type
Connection spigot/Clamping sleeve	G1/2"	180	145	155	56	200	Steel	DIN16282 - Shape A	0,77	SI001-12-C
Connection spigot/Clamping sleeve	G1/2"	180	145	155	56	200	Stainless steel 1.4571	DIN16282 - Shape A	0,79	SI001-12-W





Connection	A	ØB	L1	L2	L3	L4	Material	Standard	Weight [kg]	Type
Weld-on end/Clamping sleeve	G1/2"	20x2,6	145	155	56	200	Steel	DIN16282 - Shape B	0,68	SI002-12-C
Weld-on end/Clamping sleeve	G1/2"	20x2,6	145	155	56	200	Stainless steel 1.4571	DIN16282 - Shape B	0,79	SI002-12-W



Connection	A	D	L1	L2	L3	Material	Standard	Weight [kg]	Type
Connection spigot/Clamping sleeve	G1/2"	56	275	95	130	Steel	DIN16282 - Shape C	0,77	SI003-12-C
Connection spigot/Clamping sleeve	G1/2"	56	275	95	130	Stainless steel 1.4571	DIN16282 - Shape C	0,68	SI003-12-W



Connection	A	ØB	D	L1	L2	L3	Material	Standard	Weight [kg]	Type
Weld-on end/Clamping sleeve	G1/2"	20x2,6	56	240	95	130	Steel	DIN16282 - Shape D	0,68	SI004-12-C
Weld-on end/Clamping sleeve	G1/2"	20x2,6	56	240	95	130	Stainless steel 1.4571	DIN16282 - Shape D	0,68	SI004-12-W

Illustrations non-binding  
Design, dimensional and material changes reserved

