

## electrical actuator series SQ..-0

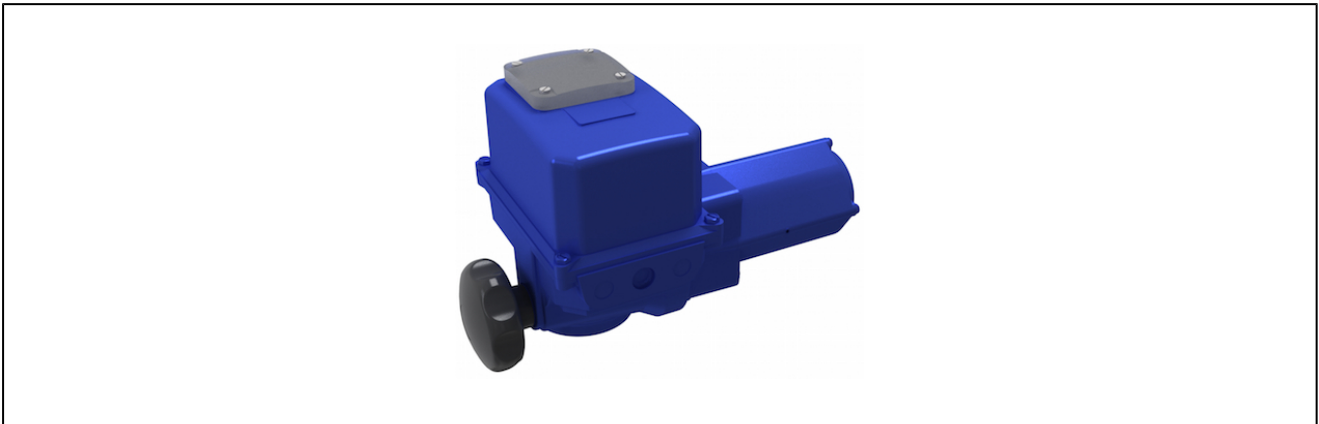

design	electric gear motor with additional emergency hand wheel with internal motor-protection, heating resistance, gear box self blocking
materials	body aluminium die-cast painted blue
mounting position	any, preferable in upright position
temperature range	-20...+70°C
electrical data	
type of current	see table "motor data"
electrical connection	above 2 cable gland M20
limit switch-off	above integrated limit switch SQ4...SQ15 single-phase motor: limit switch-off is wired (wired internally) all other voltages or types: position switches are on terminals
torque switches	SQ4...SQ15: none SQ20...SQ100: 2 pieces
duty cycle	30% ED on average 20 - 30 operations per day
protection class	IP67 according to EN 60529 by correctly mounted cable inlet (protection against dust and water jet)
special version	low temperature equipment -40...+70°C, high temperature version 0...+90°C, control actuators, more resistant coating, explosion proof type, IP68

type code

		SQ 6 - 0 A 6 - Q 14 - 01	
		4	
		6	
		10	
		15	
		20	
		25	
		60	
		80	
		100	
<b>type</b>			
<b>actuator typ</b>	on/off actuator	0	
<b>voltage</b>	24VDC	A	
	230V/50Hz	B	
	400V/50Hz	M	
<b>operating time (Sekunden)</b>	5	5	
	6	6	
	10	10	
	15	15	
	30	30	
	60	60	
	80	80	
<b>socket machining</b>	without adapter blank position		
	key	K	
	flat	W	
	square	Q	
<b>socket size</b>	9	9	
	11	11	
	14	14	
	16	16	
	17	17	
	18	18	
	19	19	
	20	20	
	22	22	
	27	27	
	28	28	
	30	30	
	32	32	
<b>special version</b>	described in the article description	01,02,03...	
	low temperature equipment -40...+70°C		
	high temperature version 0...+90°C		
	other operating times		
	explosion proof type		

## dimensions

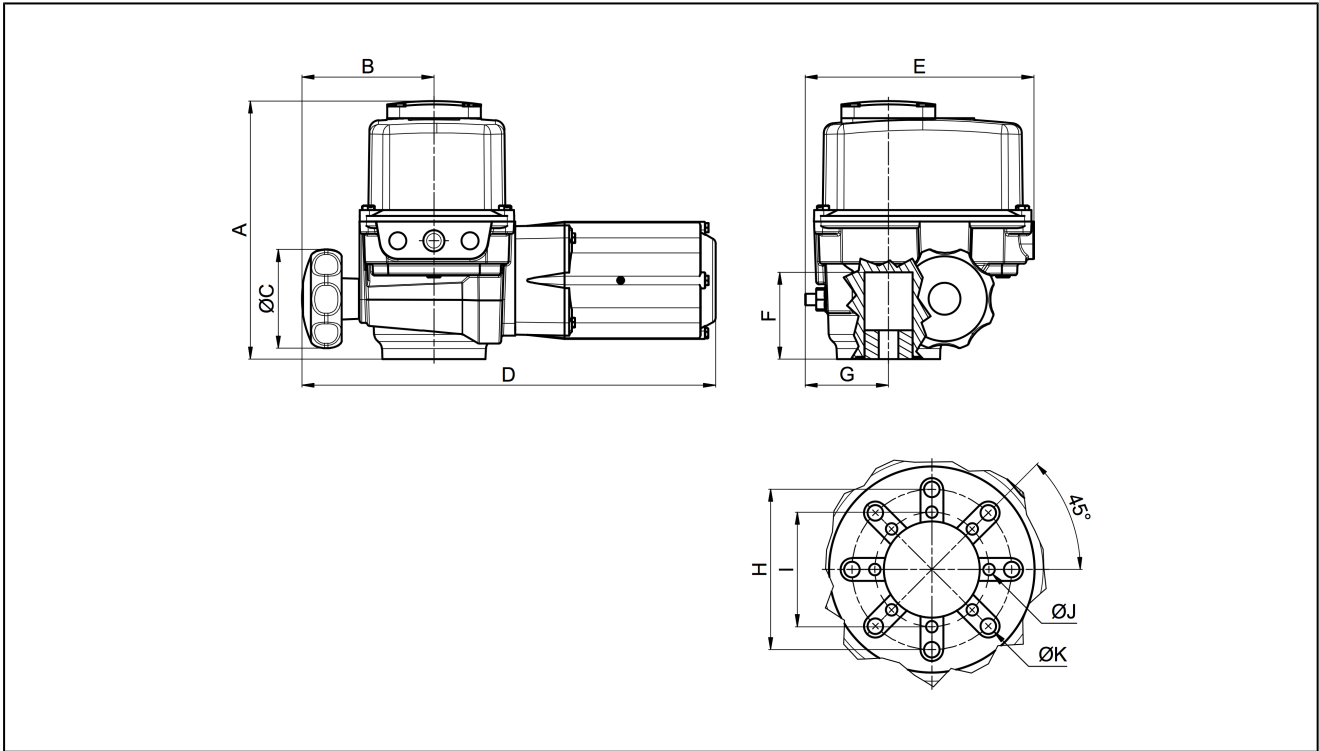

A	B	C	D	E	F	G	H	I	flange ISO 5211	type
225	116	90	273	200	74	73	70	50	F05/F07	SQ4
225	116	90	319	200	74	73	70	50	F05/F07	SQ6
225	116	90	362	200	74	73	70	50	F05/F07	SQ10
225	116	90	362	200	74	73	70	50	F05/F07	SQ15
180	226	160	538	313	-	84	102	70	F07/F10	SQ20
180	226	160	538	313	-	84	102	70	F07/F10	SQ25
180	227	250	587	313	-	84	102	70	F07/F10	SQ60
221	227	250	587	313	-	84	125	-	F12	SQ80
371	-	300	521	425	-	-	125	-	F12	SQ100

## socket machining

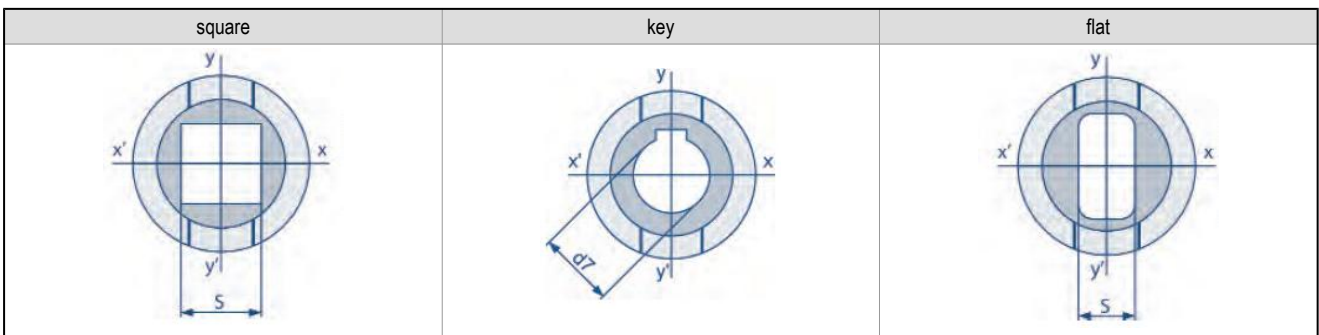

type	square s	key Ød7	flat s
SQ4 / SQ6 / SQ10	9 / 11 / 14 / 16 / 17 / 19	14 / 18 / 20 / 22	14
SQ15	9 / 11 / 14 / 16 / 17 / 19	14 / 18 / 20 / 22	14 / 19
SQ20 / SQ25	14 / 17 / 19 / 22	22 / 28 / 30	14 / 17 / 19 / 22
SQ60	14 / 17 / 19 / 22 / 27	22 / 28 / 30 / 32	14 / 17 / 19 / 22
SQ80	22 / 27 / 36	22 / 28 / 30 / 35 / 40	14 / 17 / 19 / 22
SQ100	22 / 27 / 36	28 / 30 / 35 / 40 / 48 / 50 / 60	32 / 36

**motor data - single-phase motor, 230V 50Hz**

max. torque [Nm]	operating time for 90° [s]	power [W]	speed [1/min]	rated current [A]	starting current [A]	weight [kg]	type
45	6	30	1500	0,8	0,9	6	SQ4
60	6	30	1500	0,6	0,9	7	SQ6
100	6	60	1500	1,2	1,7	7	SQ10
150	15	30	1500	0,6	0,9	7	SQ15
200	5	200	1500	0,6	0,9	25	SQ20
250	5	400	1500	4,0	9,0	25	SQ25
600	30	60	1500	1,2	1,7	20	SQ60
800	30	150	1500	2,0	3,0	21	SQ80
1000	30	200	1500	2,5	3,5	47	SQ100

**motor data - 3-phase motor, 400V 50Hz**

max. torque [Nm]	operating time for 90° [s]	power [W]	speed [1/min]	rated current [A]	starting current [A]	weight [kg]	type
60	6	30	1500	0,3	0,5	7	SQ6
100	6	100	1500	0,6	1,1	7	SQ10
150	15	30	1500	0,3	0,5	7	SQ15
200	5	100	1500	0,6	1,1	25	SQ20
250	5	150	1500	0,7	2,1	25	SQ25
600	30	60	1500	0,3	0,8	20	SQ60
800	30	60	1500	0,3	0,8	21	SQ80
1000	30	100	1500	0,6	1,2	47	SQ100

**motor data - direct current 24V DC**

max. torque [Nm]	operating time for 90° [s]	power [W]	speed [1/min]	rated current [A]	starting current [A]	weight [kg]	type
60	9	60	1500	5,3	9,9	7	SQ6
100	52	60	1500	5,3	9,9	7	SQ10
150	22	60	1500	5,3	9,9	7	SQ15
250	8	160	1500	13	40	25	SQ25
600	45	80	1500	6,2	19	20	SQ60
800	45	80	1500	6,2	19	21	SQ80
1000	45	160	1500	13	40	47	SQ100

**electrical connection plan - limit switch: SQ04...SQ100 3-phase motor, SQ20...SQ100 single-phase motor, direct current**

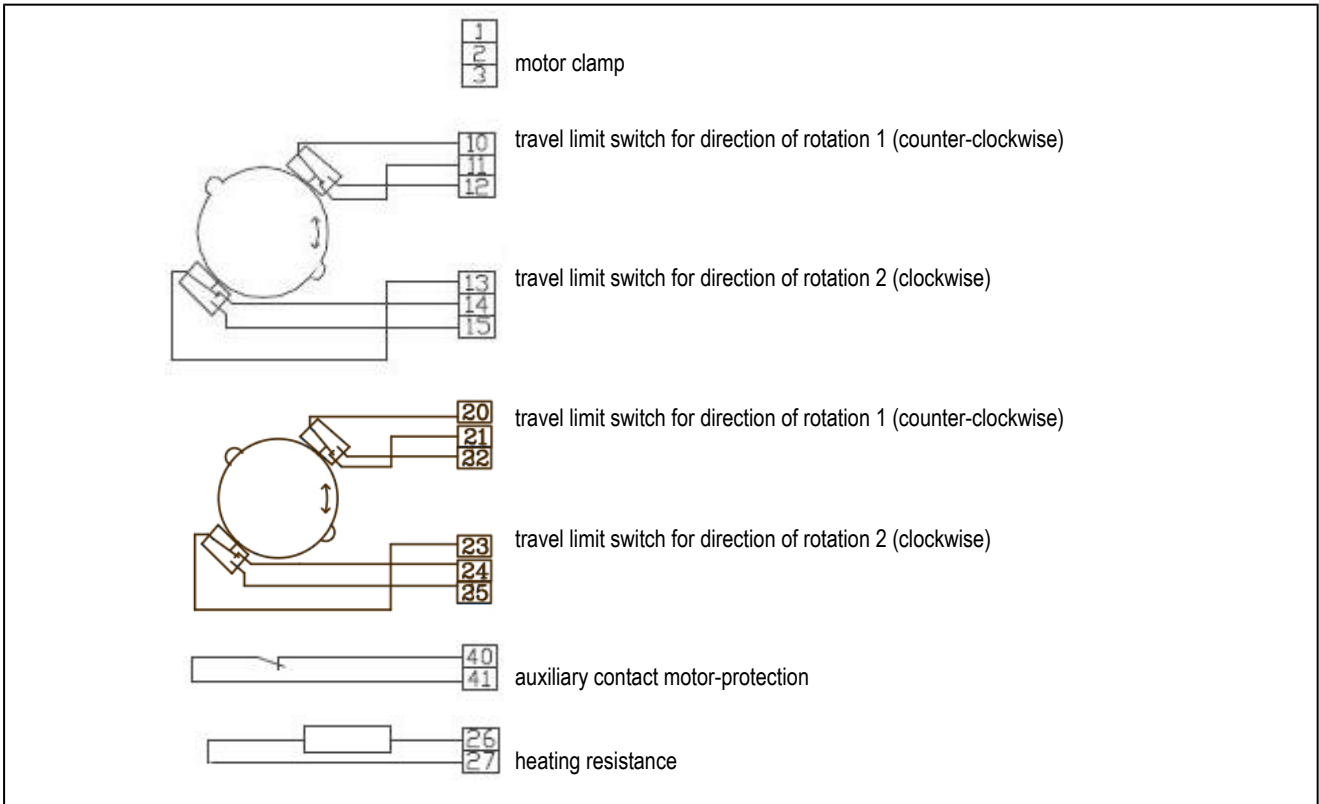

**electrical connection plan - for motor: SQ04...SQ100 3-phase motor, SQ20...SQ100 single-phase motor, direct current**

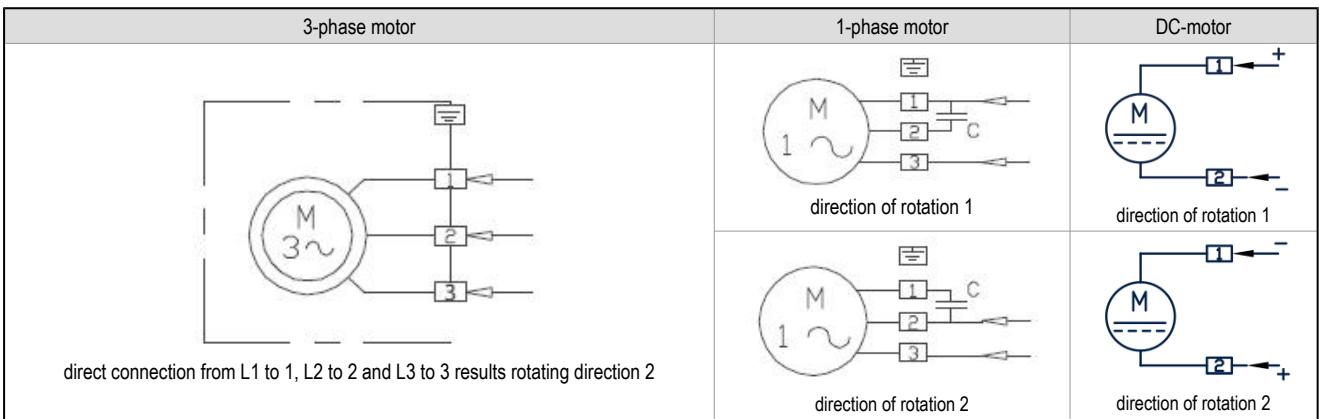

**optional accessories**

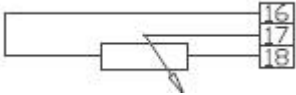
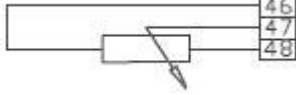
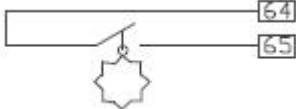
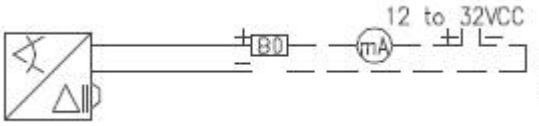
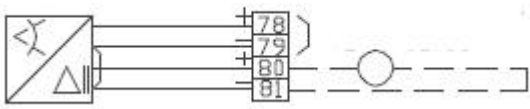
<p style="text-align: center;">potentiometer</p> 	<p style="text-align: center;">second potentiometer</p> 	<p style="text-align: center;">flash contact (indicator for running motor)</p> 
<p>electrical position transmitter 2-wire connection</p>		
		<p>I = 4...20mA</p>
<p>electrical position transmitter 2 or 3 wire connection</p>		
		<p>78 and 79: power supply 12...32VDC I = 4...20mA</p>

**example for electric wiring - wired internally only with 1-phase motor SQ4...SQ15**

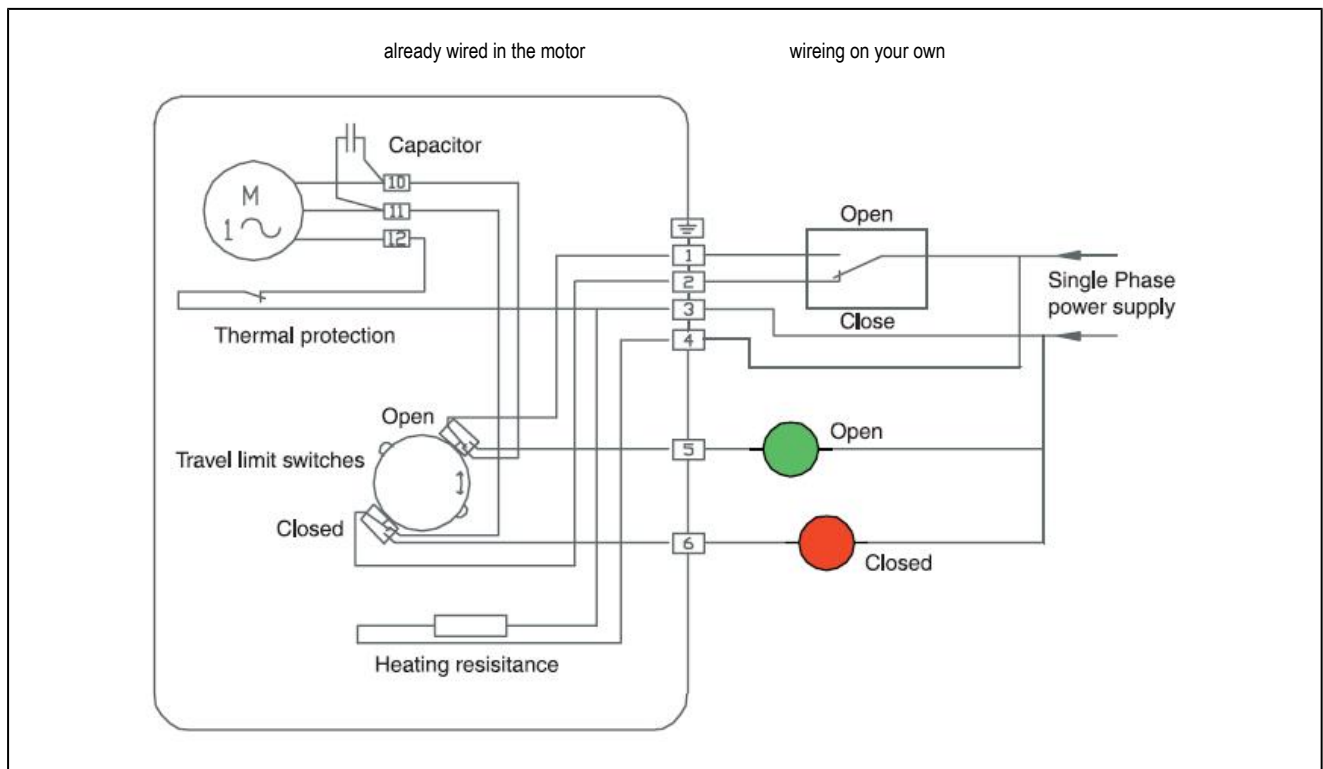

example for electric wiring SQ20...SQ100

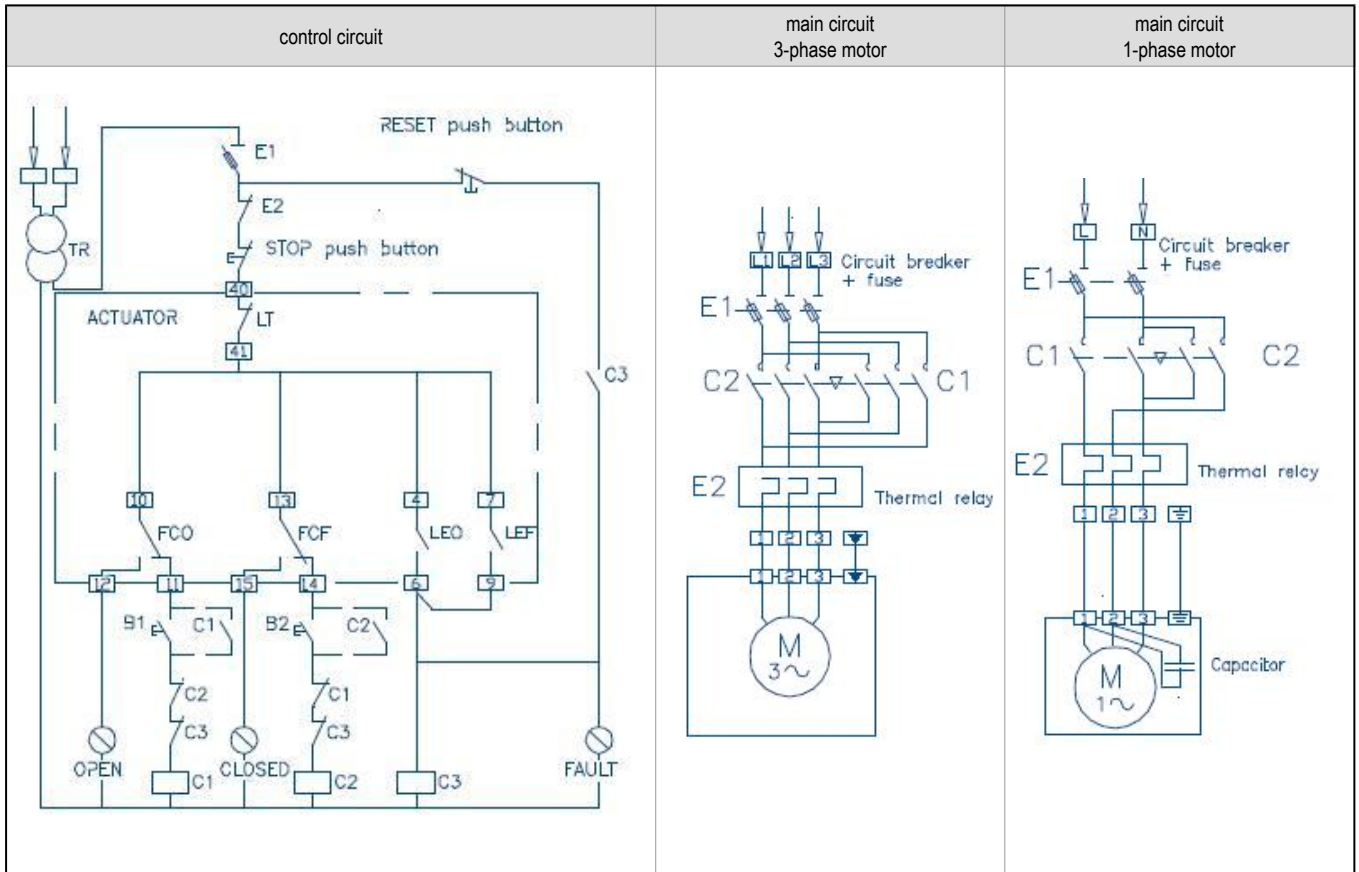

explanation		
E1...switch with fuse E2...thermally motor-protection C1...contactor OPENING C2...contactor CLOSING C3...contactor ERROR	FCO...limit switch OPENING FCF...limit switch CLOSING LEO...torque limitation OPENING LEF...torque limitation CLOSING	LT...thermally switch in the motor TR...transformer S1...push-button OPENING S2...push-button CLOSING

illustrations are non-binding  
 all designs, configurations, measurements and materials are subject to change without prior notice