

High precision test gauges

for stand-alone process connection

High precision pressure gauges

Applications and features

- Test and reference measuring device for highly accurate comparison measurements in official test institutes and commercial test laboratories
- Bayonet housing allows correcting adjustments after calibrations
- Suitable for gaseous, low-viscosity and non-crystallising measuring media that do not corrode brass
- Utmost measurement accuracy: up to class 0.25; i.e. +/- 0.25% of the span
- Pointer adjustment screw adjustable from the outside, for zero point and initial value correction
- Standard reading ranges acc. to EN 837-1 between -1 bar and 1000 bar



Nominal size	Accuracy	Connection	Low radial	Centre back mount	Up radial	Lower back mount	Housing
NS 160	Cl 0.25	G 1/2B	•			•	CrNi steel, 1.4301
NS 160	Cl 0.6	G 1/2B	•			•	Sheet steel, black
NS 250	Cl 0.25	G 1/2B	•			•	CrNi steel, 1.4301
NS 250	Cl 0.6	G 1/2B	•			•	Sheet steel, black

Technical features		Technical features	
Type standard	in conformity with EN 837-1	Gaseous measuring media	applicable
Sensing element	Bourdon tube element (circular up to 40bar, helical starting from 60bar)	Fluid measuring media	applicable
Scale ranges (negative overpressure)	-1 bar ... 0 bar	Viscous measuring media	not applicable
Scale ranges (positive overpressure)	0 bar ... 1000 bar	Crystallising measuring media	not applicable
Scale ranges (neg./pos. overpressure)	-1 bar ... +1,6 bar	Aggressive measuring media	not applicable
Scale on dial	linear, 270 angle degrees	Housing type	Housing with bayonet catch
End stop on dial	without end stop pin	Ingress protection of the housing	IP54 acc. EN 60529 / IEC 528
Fluctating pressure limit	0.9-fold span	Type of mounting	stand-alone process connection
Steady pressure limit	1.0-fold span	Sensing element material	brass
Short time pressure limit	1.3-fold span	Connection material	brass
Temperature effect on accuracy (+/- of T ref.)	max. +/-0.4% of span per +/-10 K of reference temp.	Window	scratch resistant instrument glass
Measuring medium temperature	max. +60°C	Material of instrument dial	Aluminium pure white coated, black imprint
Ambient temperature	-20°C to +60°C	motion work	brass
Storage temperature	-20°C to +60°C	Pointer	Knife edge pointer, aluminum, anodized
		Red mark pointer	see options
		Damping fluid	see options

High precision test gauges

for stand-alone process connection

High precision pressure gauges

Technical features		Technical features	
Sealing materials	Housing: NBR (Perbunan), silicone free	Important notes	Cl 0.25: parts in contact with measuring media 1.4571 and mirror scale
Protection and safety design	see options		
ATEX suitability	acc. to ATEX manufacturer declaration		

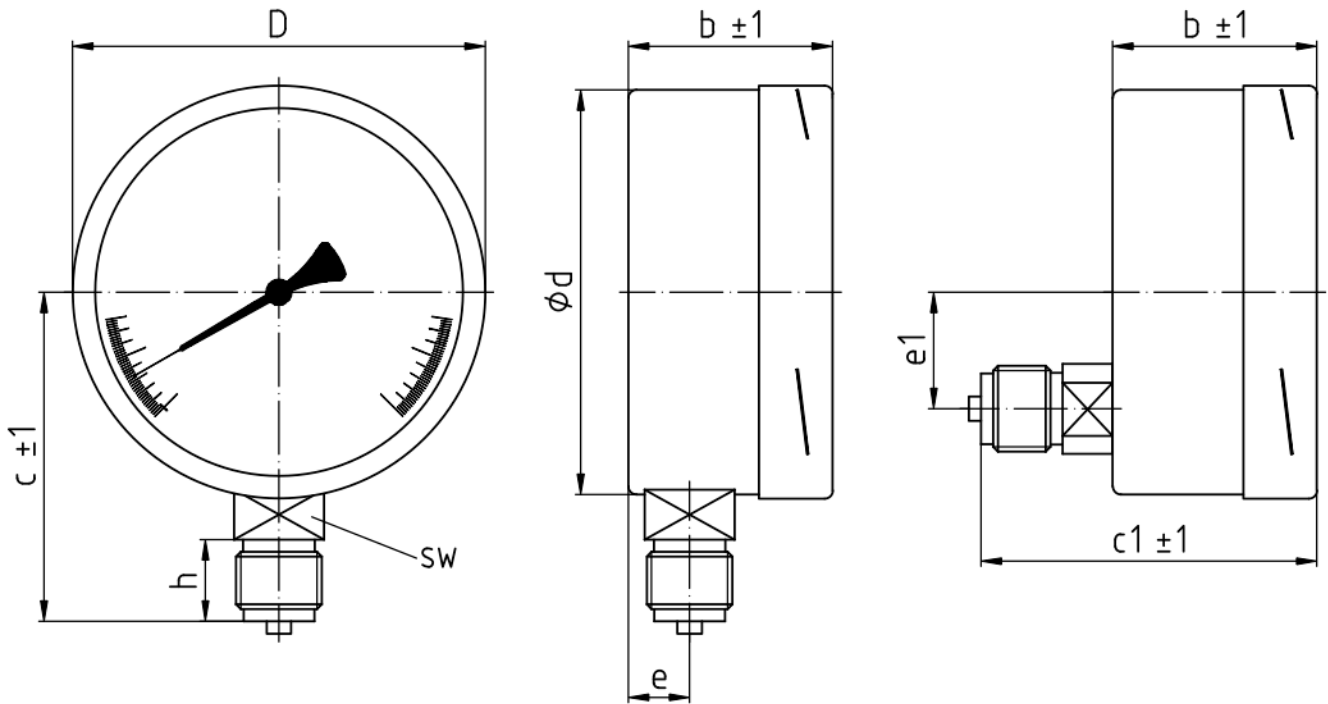

Technische Änderungen sowie Satz- und Druckfehler vorbehalten.

NG	D	d	b	c	c1	e	e1	h	SW
NG 160	161	159	50	118	82	16	28,5	20	22
NG 250	251	249	57	165	88	16	51,0	20	22

Options		Options	
Max. drag pointer, resettable	from 1 pcs	Laminated safety glass acc. to S1 (EN 837-1)	from 1 pcs
Min. drag pointer, resettable	from 1 pcs	Pressure relief opening acc. to S2 (EN 837-1)	from 1 pcs
Min. and max. drag pointer, resettable	from 1 pcs	Impact protection cap	from 1 pcs
Red marking on instrument dial	from 1 pcs	Oil and grease free design incl. certificate	from 1 pcs
Red mark pointer, adjustable from the outside	from 1 pcs	Oxygen design, incl. certificate	from 1 pcs
Special scale for standard reading/measuring range	from 1 pcs	Silicone free design, incl. Factory Confirmation	from 1 pcs
Special reading/measuring range	from 1 pcs	Acid gas design, incl. certificate	from 1 pcs
Text inscription in black block letters	from 1 pcs	Material test report 2.2 (EN 10204)	from 1 pcs
Monochrome logo and text inscription	from 1 pcs	Material inspection certificate 3.1 (EN 10204)	from 1 pcs
Polychrome graphic, logo and text inscription	from 1 pcs	Factory calibration with inspection certificate 3.1 (EN 10204)	from 1 pcs
Throttle screw 0.3mm	from 1 pcs	Internationally recognised calibration (ÖKD)	from 1 pcs
Throttle screw 0.6mm	from 1 pcs	Preparation for official verification	from 1 pcs
Special threads, e.g. NPT, M12x1.5	from 1 pcs	Verification: stamping mark	from 1 pcs

V20151118

High precision test gauges

for stand-alone process connection

High precision pressure gauges

Options		Options	
Verification: stamping mark and verification certificate	from 1 pcs	Silicone oil filling for cl. 0.6	from 1 pcs
Motion work made of 1.4571 Cl. 0.6 only)	from 1 pcs	Glycerine oil filling for cl. 0.6	from 1 pcs
Mirror scale starting from cl. 0.25	from 1 pcs	Almond oil, FDA approved	from 1 pcs