

2/2-Way solenoid valve direct-acting Series SL001

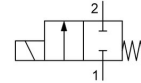

normally closed (de-energized closed)

Design type	2/2-way solenoid valve with elastomer seal, direct-acting, normally closed (de-energized closed)
Connection	G1/8"...G1/4" according to ISO228/1
Materials	Body and guide tube Brass, Internal parts Stainless steel similar to 1.4104, Seal NBR (Perbunan) or FKM
Mounting type	Installation in rigid piping system or via mounting thread
Mounting position	any
Application range	gaseous and liquid media that do not attack the materials used
Viscosity	max. 37mm ² /s (cst)
Switching time	10...30ms
Switching frequency	max. 300/min
Medium temperature	depending on the sealing material and Solenoid coil
Ambient temperature	see table "Solenoid coils"

Electrical data:

Coil type	Type BDA, Connector width 32mm (Standard coil) Type BDV, Connector width 32mm (Coil for humid environment)
Electrical connection	Appliance socket according to EN175301-803 Form A (see separate data sheet)
Standard voltage	230V/50-60Hz, 24V/50-60Hz, 24VDC
Special voltages	12...380V/50Hz or 60Hz, 12...110VDC
Permissible voltage fluctuation	AC +10%/-15% DC +10%/-5%
Power consumption	see table "Power consumption of the solenoid coils"
Duty cycle	100% duty cycle (continuous operation)
Degree of protection	IP65 according to EN 60529 with correctly mounted device connector (protection against dust ingress and water jets)
Application note	When ordering, please specify voltage and type of current. We always recommend installing a strainer upstream to prevent malfunctions in the event of contamination of the medium.. These valves can also be used for rough vacuum applications. The maximum nominal housing pressure can be 40 bar. The maximum switchable pressure is the differential pressure between the valve inlet and outlet. For DC, the specified differential pressure values apply for a medium temperature of max. 80°C and an ambient temperature of 40°C. At higher media temperatures, the permissible differential pressure decreases by 0.4% per °Celsius.



Type code

SL001		-	18	-	1,7	-	V	-	A	S	01	-	01
Connection	G1/8"		18										
	G1/4"		14										
Connection													
Nominal size	1,7mm				1,7								
	2,2mm				2,2								
	2,8mm				2,8								
	4mm				4								
Seal	NBR (Leave blank)												
	FKM											V	
Coil	without coil - Leave blank												
	BDA Standard coil - Approval CE									A			
	BDV Coil for humid environment - Approval CE-CSA-UL-VDE									C			
Device connector	without device connector - Leave blank												
	Standard										S		
	with integrated yellow LED and VDR										L		
	with moulded PVC cable (2 m)										M		
Voltage	220-230V/50-60Hz										01		
	230V/50-240V/60Hz										02		
	24VDC										03		
	24V/50-60Hz										04		
	12VDC										05		
	110VDC										07		
	42V/50Hz										10		
	48V/50Hz										11		
	110V/50-60Hz										13		
	110V/50-120V/60Hz										14		
	115V/60Hz										15		
	380V/50-60Hz										16		
Special version	described in the item text										01,02		

Possible applications of the individual sealing materials

Material	Medium temperature	Application examples
NBR	-10...+90°C	Air, Water, neutral gases and liquids
FKM	-10...+140°C	Gasoline, Diesel, Air, Oils, Water, neutral gases and liquids

Solenoid coils

Type	Degree of protection	Application range	Ambient temperature	Approvals
BDA	IP65	Medium temperature up to max. 120°C	-10...+40°C	CE
BDV	IP65	Medium temperature up to max. 160°C, high humidity	-20...+60°C	CE-CSA-UL-VDE



Power consumption of the solenoid coils

Voltage	Tightening torque (Alternating current) VA	Holding force (Alternating current) VA	Holding force (Direct current) operating temperature W	Type
12VDC	-	-	8	BDA08012CS
24V/50-60Hz	25	14,5	-	BDA08024DS
24VDC	-	-	8	BDA08024CS
42V/50Hz	25	14,5	-	BDA08042AS
48V/50Hz	25	14,5	-	BDA08048AS
110VDC	-	-	8	BDA08110CS
110V/50-60Hz	25	14,5	-	BDA08110DS
115V/60Hz	25	14,5	-	BDA08115BS
220-230V/50-60Hz	25	14,5	-	BDA08223DS
380V/50-60Hz	25	14,5	-	BDA08380DS
24VDC	-	-	11	BDV08024CY
24V/50-60Hz	25	17	-	BDV08024DY
110V/50Hz 120V/60Hz	25	15	-	BDV080110AY
230V/50Hz 240V/60Hz	25	16	-	BDV08230AY

Permissible differential pressures in bar and Kv value

Connection G	Nominal size DN[mm]	AC	DC	Kv value [m³/h]	Type
1/8"	1,7	0 - 30	0 - 20	0,09	SL001-18-1,7
1/8"	2,2	0 - 20	0 - 15	0,13	SL001-18-2,2
1/8"	2,8	0 - 14	0 - 10	0,21	SL001-18-2,8
1/8"	4,0	0 - 6	0 - 3	0,30	SL001-18-4
1/4"	1,7	0 - 30	0 - 20	0,09	SL001-14-1,7
1/4"	2,2	0 - 20	0 - 15	0,13	SL001-14-2,2
1/4"	2,8	0 - 14	0 - 10	0,21	SL001-14-2,8
1/4"	4,0	0 - 6	0 - 3	0,30	SL001-14-4

Dimensions

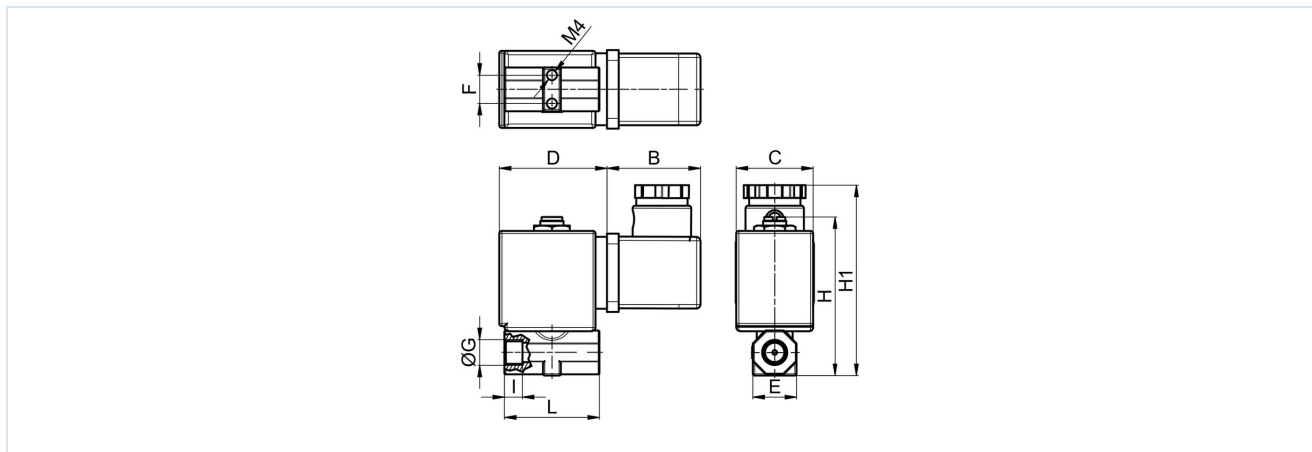

Connection G	B	C	D	E	F	H	H1	L	I	Weight [approx. kg]	Type
G1/8"	36	30	42	17	11	63	75	37	7	0,2	SL001-18
G1/4"	36	30	42	17	11	63	75	37	7	0,2	SL001-14

Illustrations non-binding
Design, dimensional and material changes reserved

Armatures / Solenoid valves for liquids and gases / 2/2-way solenoid valves - directly operated / 2/2-way solenoid valve Series SL001

Version 12

137876 / Generated 2026/23 EN

MADE IN EUROPE

+43 512 52076

austria@stasto.eu

© STASTO Automation KG

www.stasto.com

Open series online

Page 3 / 3

