

Screw-in flow control valve Series RSS

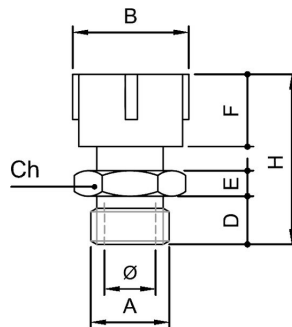

Design type	Screw-in flow control with silencer
Actuation	via throttle screw (sintered metal body), self-locking
Connections	G1/8" ... G1/2" after ISO228/1
Material	Body Nickel-plated brass, Silencer element made of sintered bronze
Medium	Compressed air, neutral gases
Medium temperature	-20...+150°C
Operating pressure	-0,75...10bar
Mounting position	any
Application	for throttling the exhaust air and simultaneously for noise attenuation



A	Nominal size [mm] Ø	B	D	E	F	Ch	H min.	H max.	Nominal flow rate [Nl/min]	Weight [g]	Type
G1/8"	4,5	15	8	4	12	14	25	27	450	17	RSS-1/8"
G1/4"	6,5	18,5	8	4	14	17	28	30	800	29	RSS-1/4"
G3/8"	8	24,5	10	5	16	22	33	38	-	57	RSS-3/8"
G1/2"	12,5	29	12	7	18	27	39	46	1800	96	RSS-1/2"

Illustrations non-binding
Design, dimensional and material changes reserved

Pneumatics / Flow control valves / Bidirectional flow control valves / Throttle Series RSS

