

Proportional pressure regulator Series RE16, RE17



Type RE16



Type RE17

Design type	3/2-way valve with proportional solenoids and digital control, from G1/2" with flow booster
Connection	G1/8"...G1" according to ISO228/1
Materials	Housing Brass (G1/8" and G1/4"), Seals NBR, on request EPDM or FKM Internal parts Brass and Stainless steel Booster Housing Zinc die casting (G1/2" and G1"), Diaphragm NBR
Function	Secondary pressure regulation
Mounting type	Installation in piping system
Mounting position	any, preferably upright
Medium	dry, lubricated or non-lubricated and 50µm filtered compressed air or neutral gases
Medium temperature	0...+60°C
Ambient temperature	0...+60°C
Accuracy	< 0,5% from the final value
Control time	< 1s over the control range
Scope of delivery	Proportional pressure regulator without connection cable Type C012-51-CU20-4
Pneumatic characteristics	
Inlet pressure	see table
Control ranges	0...0,1bar up to 0...50bar
Flow direction	as specified in the dimensional drawing
Self air consumption	no self-air consumption

Electrical data:

Degree of protection	IP65 according to EN 60529 with correctly mounted device connector (protection against dust ingress and water jets)
Supply voltage	24VDC ±10%
Power consumption	G1/8"/G1/2"/G1" 12W, G1/4" 24W
Signal ranges	0...10V (0...20mA and 4...20mA on request)
Input resistances/burden	100KΩ with voltage actuation (0,1mA Current consumption) 250Ω with electrical actuation
Connection	M12, 5-pin
Adjustment	Factory setting adjustable via software, Zero point and full-scale value adjustable in %, different control modes adjustable (Software available on request)



Dimensions Series RE16

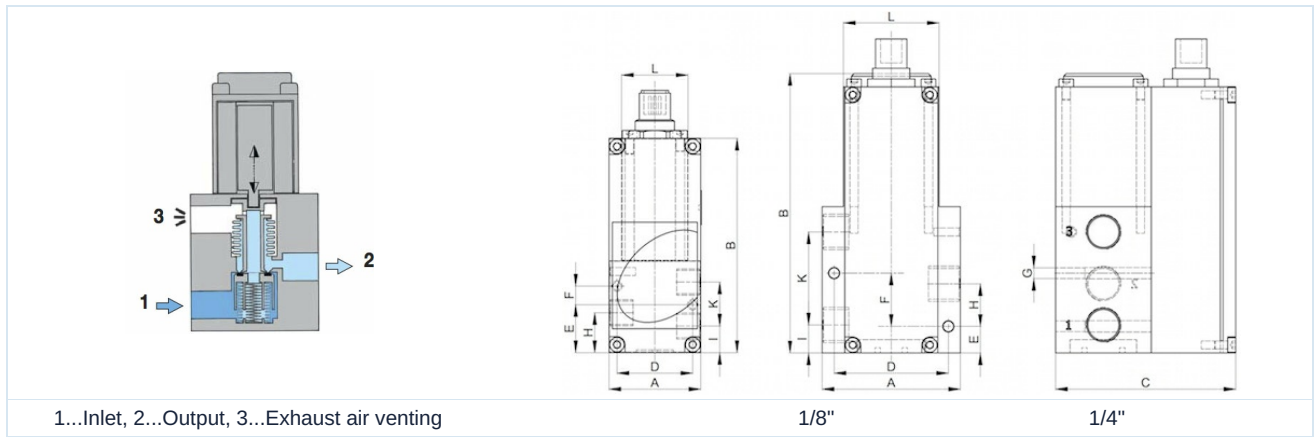

Thread	DN[mm]	A	B	C	D	E	F	G	H	I	K	L	Weight [approx. kg]	Type
G1/8"	3	35	81	57	29	18	7	M4	15	10	16	25	0,55	RE16-18
G1/4"	6	52	105	68	43	10	20	M4	16	11	34	35	1,54	RE16-14

Dimensions Series RE17 (Booster)

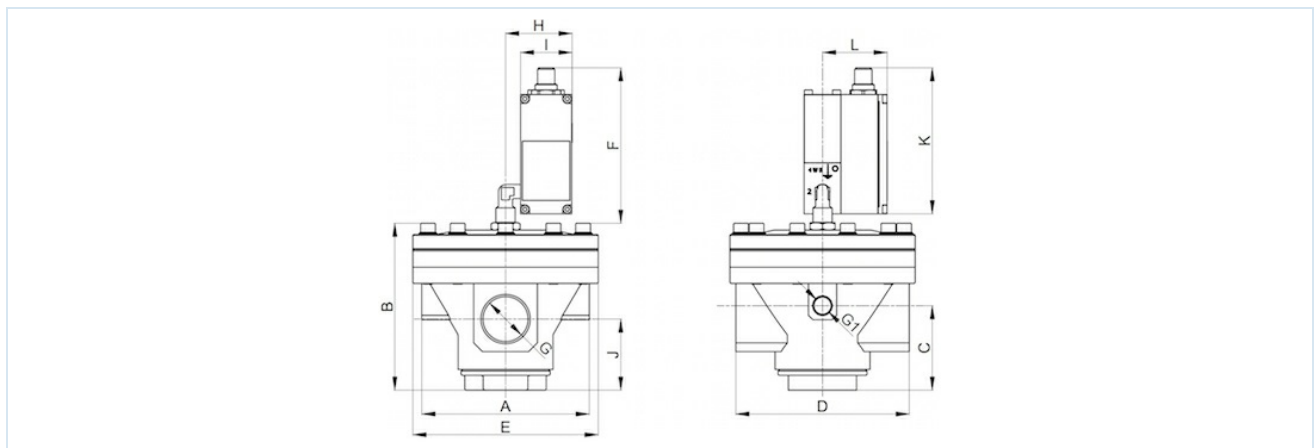

Thread G	A	B	C	D	E	F	G1	H	I	J	K	L	Weight [approx. kg]	Type
G1/2"	67	68	33	82	82	110	1/4"	45	35	33	99	44	1,40	RE17-12
G1"	113	113	57	117	128	105	1/4"	45	35	48	99	44	2,30	RE17-10



Type RE16

Thread	max. inlet pressure [bar]	Control range [bar]	Flow rate at 6 bar [Nl/min]	Type
G1/8"	2	0...1	210	RE16-18-0/1
G1/8"	12	0...6	210	RE16-18-0/6
G1/8"	12	0...10	210	RE16-18-0/10
G1/4"	2	0...1	700	RE16-14-0/1
G1/4"	12	0...6	700	RE16-14-0/6
G1/4"	12	0...10	700	RE16-14-0/10

Type RE17

Thread	max. inlet pressure booster [bar]	max. inlet pressure proportional regulator [bar]	Control range [bar]	Flow rate at 6 bar [Nl/min]	Type
G1/2"	25	2	0...1	5200	RE17-12-0/1
G1/2"	25	12	0...6	5200	RE17-12-0/6
G1/2"	25	12	0...10	5200	RE17-12-0/10
G1"	40	2	0...1	15000	RE17-10-0/1
G1"	40	12	0...6	15000	RE17-10-0/6
G1"	40	12	0...10	15000	RE17-10-0/10

Control time, End point and zero point adjustment

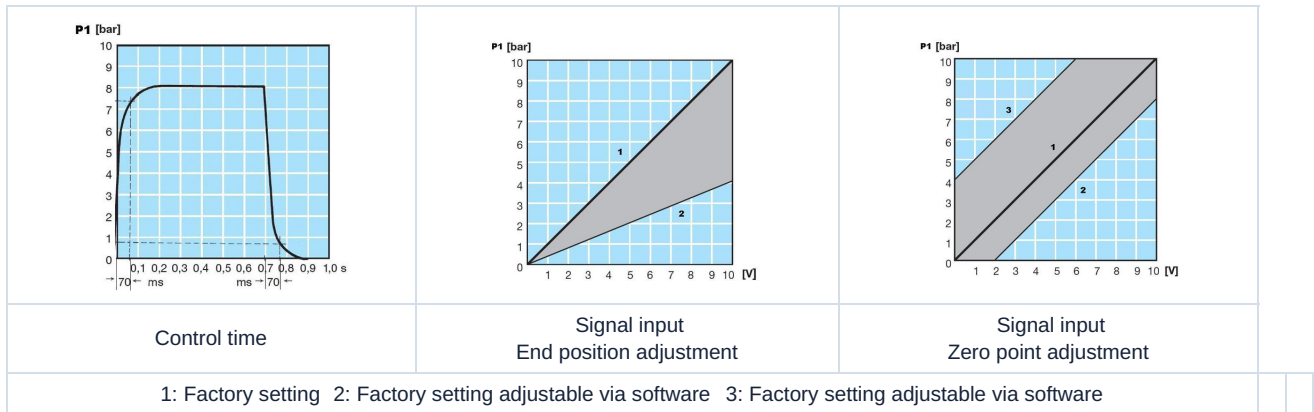

Connection diagram

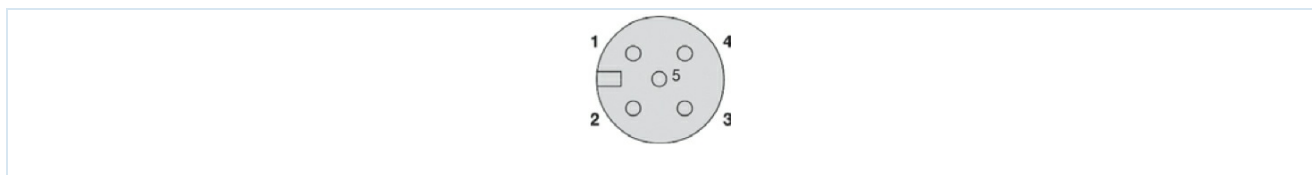

Core colors Socket M12x1 including cable 2m Type C012-51-CU20-4

Description	5-core	Pin
24V Supply +	brown	1
Setpoint +	white	2
Supply ground	blue	3
Analog ground		
Actual value	black	4
electrical pressure switch PNP	grey	5
EMC shielding	Shield	Housing

Illustrations non-binding
Design, dimensional and material changes reserved

