

Pinch valve with pneumatic actuation Series VF, DN40-DN200



Design type	direct-acting, with replaceable hose insert and cylindrical, unrestricted passage
Connection	Flanges according to EN1092-1 PN10
Materials	Housing Aluminium, Hose insert Natural rubber abrasion-resistant, Cone flanges Aluminium with Steel bushings, Screws Steel
Mounting type	Installation in rigid piping system
Mounting position	any
Application range	dusty products (Cement, Chalk, Plaster of Paris, Flour, etc.), Granules, Sand, Clay, Slurries, Pastes, contaminated fluids, Slurries
Medium temperature	-10...+80°C
Operating pressure	see table
Control pressure	1,8...2,5 bar higher than the respective operating pressure, max. control pressure 8bar
Control medium	Compressed air, Water or neutral gases
Approvals	ATEX on request
Special versions	Taper flanges with stainless steel bushings, other materials for hose inserts, Flange sleeves



Dimensions

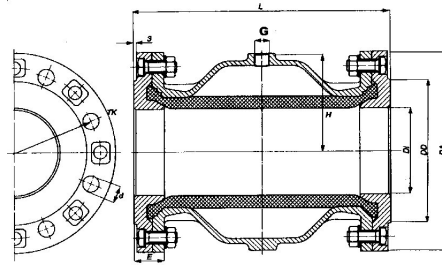

Nominal size DN[mm]	max. operating pressure [bar]	DA	DD	DI	d	Screws	TK	E	G	H	L	Control volume [l]	Weight [approx. kg]	Type
40	6	150	88	40	18	4	110	28	G1/4"	51	155	0,2	2,9	VF4003X.31.30LA
50	6	165	102	50	18	4	125	30	G1/4"	60	183	0,3	3,7	VF5003X.31.30LA
65	6	185	122	65	18	4	145	28	G1/4"	76	183	0,5	4,3	VF6503X.31.30LA
80	6	200	138	80	18	8	160	31	G1/4"	90	228	1,0	5,6	VF8003X.31.30LA
100	6	220	158	100	18	8	180	35	G1/4"	107	280	1,7	8,4	VF10003X.31.30LA
125	6	250	184	118	18	8	210	40	G1/4"	130	348	3,5	12,0	VF12503X.31.30LA
150	6	285	212	145	22	8	240	43	G1/4"	155	418	7,0	17,0	VF15003X.31.30LA
200	4	340	268	190	22	8	295	60	G3/8"	200	558	15,5	35,0	VF20003X.31.30LA

Illustrations non-binding

Design, dimensional and material changes reserved

[Armatures](#) / [Valves, butterfly valves and gate valves - automatically operated](#) / [Pinch valves - pneumatically operated](#) / [Pinch valve Series VF](#)

