

# 3/2-Way solenoid valve pilot-operated 1/8" ...1/2" Series E32W

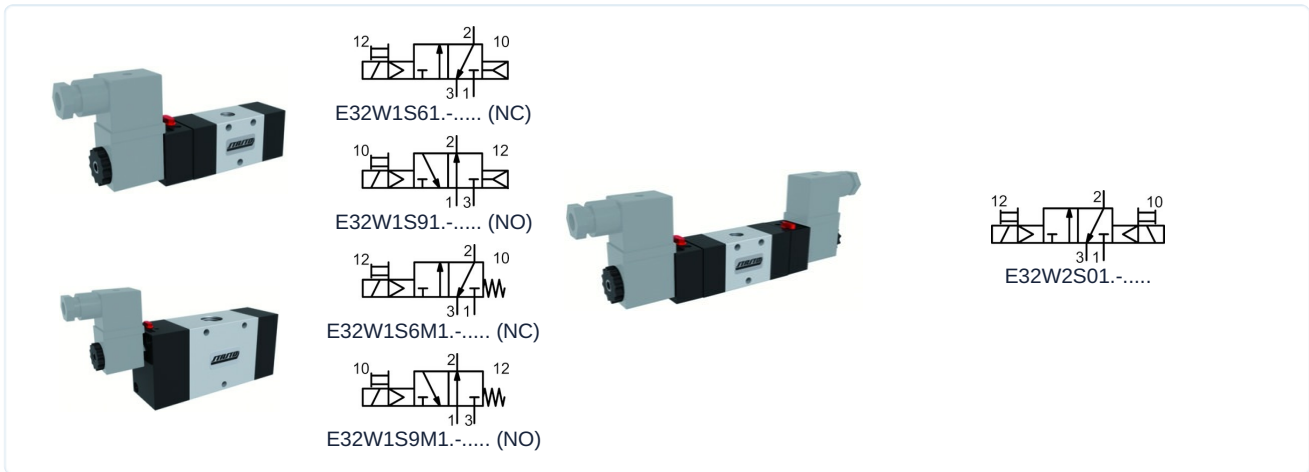

Design type	3/2-way solenoid valve pilot-operated, Actuation electric/internal pilot air, electric/spring or rather electric/electric, Manual emergency override
Connection	G1/8" ...G1/2" according to ISO228/1
Materials	Body Aluminium, Slide valve Nickel-plated aluminium, Seals NBR
Mounting type	Through holes in the valve body
Mounting position	any
Medium	filtered and lubricated or non-lubricated compressed air
Medium temperature	0...+40°C
Ambient temperature	-10...+50°C

### Electrical data:

Coil type	Type C001 (Standard coil), Connector width 22mm Type EPC (Coil for ATEX areas with 3 m cable)
Electrical connection	Appliance socket according to industrial form B (see separate data sheet)
Standard voltage	230V/50-60Hz, 24V/50-60Hz / 12VDC, 24VDC / 48V/50-60Hz
Special voltages	115V/50-60Hz, further on request
Permissible voltage fluctuation	± 10%
Power consumption	see table "Solenoid coil"
Duty cycle	100% duty cycle (continuous operation)
Degree of protection	IP65 according to EN 60529 with correctly mounted device connector (Protection against dust ingress and water jets)
Notes:	When ordering, please specify voltage and type of current CAD files are available in the STASTO Store at <a href="http://www.stasto.eu">www.stasto.eu</a>



### E32W1S . 1 . - ..... Actuation electric/internal pilot air

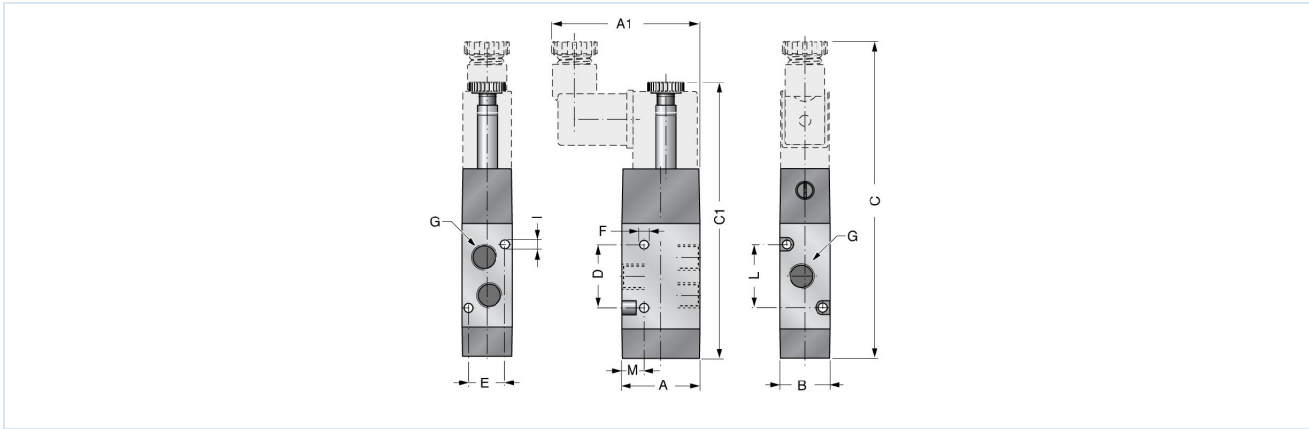

Connection G	Nominal size DN [mm]	Pressure range [bar]	A	A1	B	C	C1	D	E	F	Function	Flow rate* [Nl/min]	Type
G1/8"	6	2,2-10	30	63	26	133	119	18	23	4,25	NC	650	E32W1S618
G1/8"	6	2,2-10	30	63	26	133	119	18	23	4,25	NO	650	E32W1S918
G1/4"	8	2,2-10	40	73	30	140	125	20	30	4,25	NC	1080	E32W1S614
G1/4"	8	2,2-10	40	73	30	140	125	20	30	4,25	NO	1080	E32W1S914
G1/2"	15	2,2-10	60	60	40	181	167	40	50	5,5	NC	3500	E32W1S612
G1/2"	15	2,2-10	60	60	40	181	167	40	50	5,5	NO	3500	E32W1S912

\*Reference pressure 6bar, Reference temperature 20°C

### E32W1S . M . - ..... Actuation electric/spring

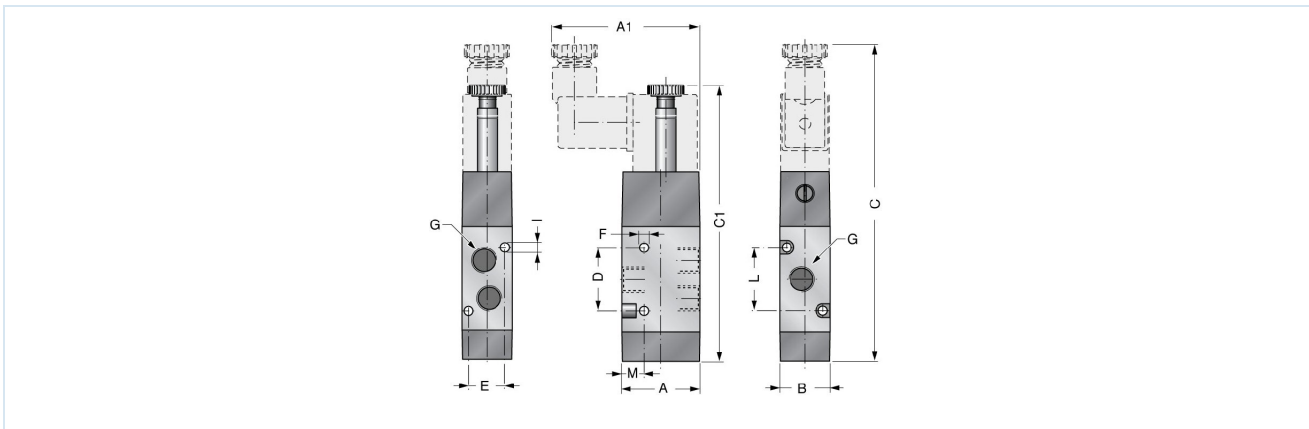

Connection G	Nominal size DN [mm]	Pressure range [bar]	A	A1	B	C	C1	D	E	F	Function	Flow rate* [Nl/min]	Type
G1/8"	6	3,2-10	30	63	26	133	119	18	23	4,25	NC	650	E32W1S6M8
G1/8"	6	3,2-10	30	63	26	133	119	18	23	4,25	NO	650	E32W1S9M8
G1/4"	8	2,5-10	40	73	30	140	125	20	30	4,25	NC	1080	E32W1S6M4
G1/4"	8	2,5-10	40	73	30	140	125	20	30	4,25	NO	1080	E32W1S9M4
G1/2"	15	2,5-10	60	60	40	172	158	40	50	5,5	NC	3500	E32W1S6M2
G1/2"	15	2,5-10	60	60	40	172	158	40	50	5,5	NO	3500	E32W1S9M2

\*Reference pressure 6bar, Reference temperature 20°C



E32W2S01 . - ..... Actuation electric/electric

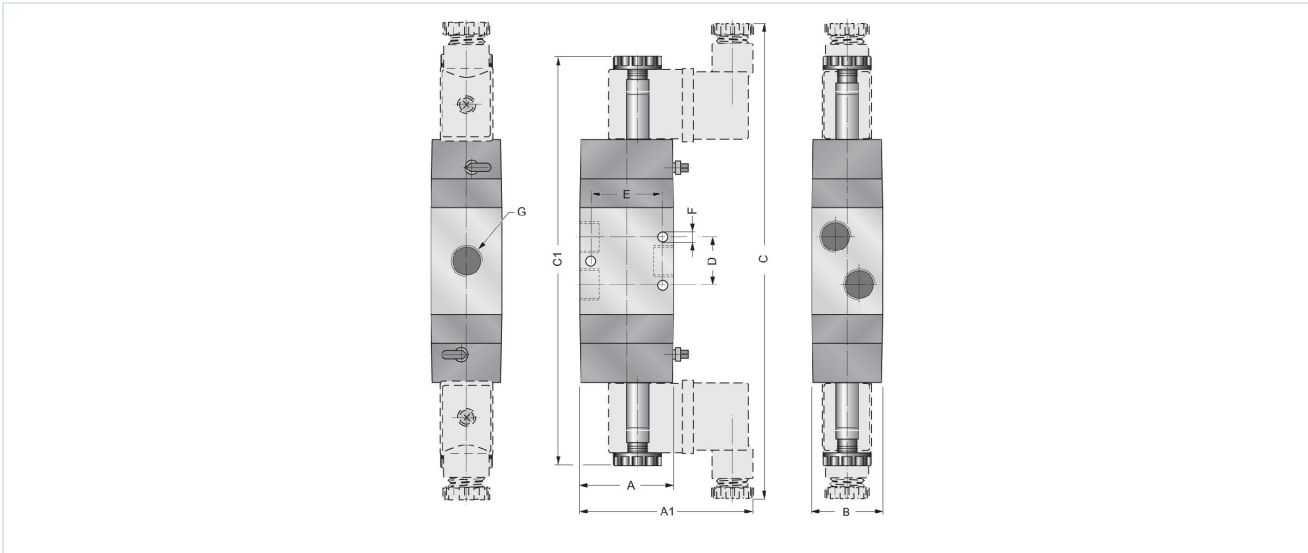



Connection G	Nominal size DN [mm]	Pressure range [bar]	A	A1	B	C	C1	D	E	F	Flow rate* [Nl/min]	Type
G1/8"	6	1,2-10	30	63	26	197	169	18	23	4,25	650	E32W2S018
G1/4"	8	1,2-10	40	73	30	203	175	20	30	4,25	1080	E32W2S014
G1/2"	15	1,2-10	60	60	40	240	212	40	50	5,5	3500	E32W2S012

\*Reference pressure 6bar, Reference temperature 20°C

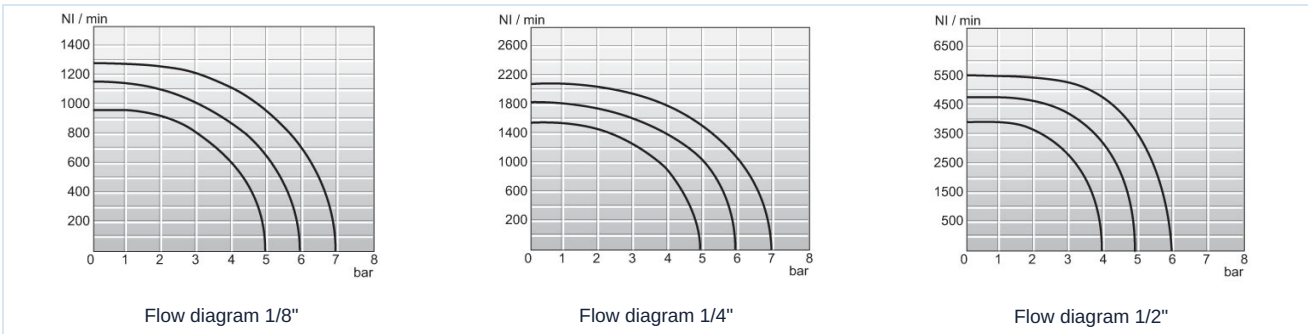
Flow diagram

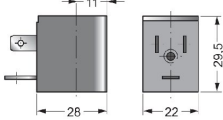

## Solenoid coils

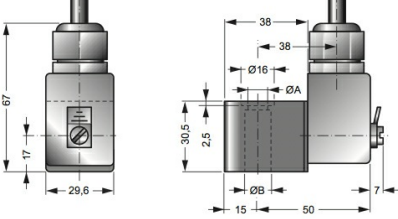
		Voltage	Degree of protection	Power consumption at 20°C	Type
		24VDC / 48V/50-60Hz	IP65	3W/5VA	C001-03
		24V/50-60Hz / 12VDC		5VA/3W	C001-04
		230V/50-60Hz		5VA	C001-22
		115V/50-60Hz		5VA	C001-23
		24VDC	Ex II 2G Ex mb IIC T5 Gb Ex II 2D Ex mb tb IIIC T95°C IP66 Db	3,0W	EPC02400
		24V/50-60Hz		3,2W	EPC02450
		110V/50-60Hz		3,2W	EPC11050
		230V/50-60Hz		3,2W	EPC23050

## Switching time, nominal max. frequency

Connection G	Switching time [ms]								nominal max. frequency [Hz]			
	E32W1S.1.-C001...				E32W1S.M.-C001...				E32W1S.1.-C001...		E32W1S.M.-C001...	
	AC ONE	AC EXHAUST	DC ONE	DC EXHAUST	AC ONE	AC EXHAUST	DC ONE	DC EXHAUST	AC	DC	AC	DC
G1/8"	17	20	19	24	17	21	19	34	29	18	13	13
G1/4"	18	33	21	44	19	35	21	46	17	14	11	11
G1/2"	43	55	45	55	47	60	49	60	13	12	8	8

Connection G	Switching time [ms]				nominal max. frequency [Hz]	
	E32W2S01.-C001...				E32W2S01.-C001...	
	AC ONE	AC EXHAUST	DC ONE	DC EXHAUST	AC	DC
G1/8"	10	10	12	12	31	23
G1/4"	11	11	14	14	27	22
G1/2"	22	22	26	26	16	15

Illustrations non-binding

Design, dimensional and material changes reserved

Pneumatics / Way-valves - electrically / pneumatically / 3/2- 5/2- 5/3-way valves - series E+V (connector size 22mm) / 3/2-way valve Series E3.

