

# Straight reducing fitting Series C-GR



Basic body with nut and cutting ring



B4 cutting ring



B3 cutting ring

Design type	Compression fitting with cutting ring, with B3 or B4 cutting ring
Tube outside diameter	6...38mm
Material	Galvanized steel
according to standard	EN ISO 8434-1 (DIN 2353)
Medium	neutral liquids and gases that do not attack the materials used
Medium temperature	B3-Cutting ring -40...+120°C B4-Cutting ring NBR -35...+100°C (FKM on request)
Operating pressure	Nominal pressure according to table

## Dimensions

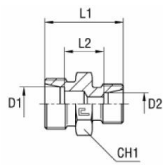

Main body

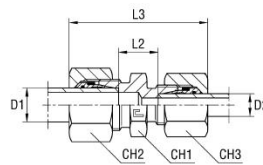

with B4 cutting ring

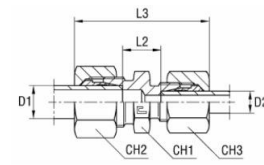

with B3 cutting ring

Series	PN [bar]	Tube diameter		L1	L2	L3	CH1	CH2	CH3	Type Main body	Type with B4 ring	Type with B3 ring
		D1	D2									
L	500	8	6	25	11	40,5	14	17	14	C-GR08/06LX	C-GR08/06ZL	C-GR08/06L
		10	6	26	12	41,5	17	19	14	C-GR10/06LX	C-GR10/06ZL	C-GR10/06L
		10	8	26	12	42	17	19	17	C-GR10/08LX	C-GR10/08ZL	C-GR10/08L
	400	12	6	27	13	42	19	22	14	C-GR12/06LX	C-GR12/06ZL	C-GR12/06L
		12	8	27	13	42,5	19	22	17	C-GR12/08LX	C-GR12/08ZL	C-GR12/08L
		12	10	28	14	43,5	19	22	19	C-GR12/10LX	C-GR12/10ZL	C-GR12/10L
		15	10	29	15	45	24	27	19	C-GR15/10LX	C-GR15/10ZL	C-GR15/10L
		15	12	29	15	44,5	24	27	22	C-GR15/12LX	C-GR15/12ZL	C-GR15/12L
		18	10	30	15,5	47	27	32	19	C-GR18/10LX	C-GR18/10ZL	C-GR18/10L
		18	12	30	15,5	46,5	27	32	22	C-GR18/12LX	C-GR18/12ZL	C-GR18/12L
	250	18	15	31	16,5	48	27	32	27	C-GR18/15LX	C-GR18/15ZL	C-GR18/15L
		22	12	32	17,5	48,5	32	36	22	C-GR22/12LX	C-GR22/12ZL	C-GR22/12L
22		15	33	18,5	50	32	36	27	C-GR22/15LX	C-GR22/15ZL	C-GR22/15L	
22		18	33	18	51	32	36	32	C-GR22/18LX	C-GR22/18ZL	C-GR22/18L	
28		18	34	19	52	41	41	32	C-GR28/18LX	C-GR28/18ZL	C-GR28/18L	
28		22	36	21	54	41	41	36	C-GR28/22LX	C-GR28/22ZL	C-GR28/22L	
	35	22	39	21	59	46	50	36	C-GR35/22LX	C-GR35/22ZL	C-GR35/22L	
	35	28	39	21	59	46	50	41	C-GR35/28LX	C-GR35/28ZL	C-GR35/28L	



## Dimensions

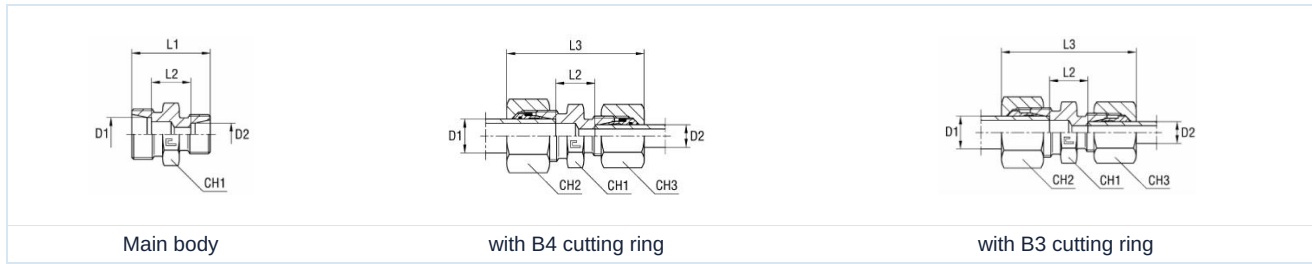

Series	PN [bar]	Tube diameter		L1	L2	L3	CH1	CH2	CH3	Type Main body	Type with B4 ring	Type with B3 ring
		D1	D2									
S	800	8	6	32	18	48	17	19	17	C-GR08/06SX	C-GR08/06ZS	C-GR08/06S
		10	6	32	17,5	48,5	19	22	17	C-GR10/06SX	C-GR10/06ZS	C-GR10/06S
		10	8	32	17,5	48,5	19	22	19	C-GR10/08SX	C-GR10/08ZS	C-GR10/08S
	630	12	6	34	19,5	50,5	22	24	17	C-GR12/06SX	C-GR12/06ZS	C-GR12/06S
		12	8	34	19,5	50,5	22	24	19	C-GR12/08SX	C-GR12/08ZS	C-GR12/08S
		12	10	34	19	51	22	24	22	C-GR12/10SX	C-GR12/10ZS	C-GR12/10S
		14	10	36	20,5	54,5	24	27	22	C-GR14/10SX	C-GR14/10ZS	C-GR14/10S
		14	12	36	20,5	54,5	24	27	24	C-GR14/12SX	C-GR14/12ZS	C-GR14/12S
		16	12	36	20	54,5	27	30	24	C-GR16/12SX	C-GR16/12ZS	C-GR16/12S
		16	14	38	21,5	58	27	30	27	C-GR16/14SX	C-GR16/14ZS	C-GR16/14S
	420	20	10	40	22	59,5	32	36	22	C-GR20/10SX	C-GR20/10ZS	C-GR20/10S
		20	12	40	22	59,5	32	36	24	C-GR20/12SX	C-GR20/12ZS	C-GR20/12S
		20	16	42	23	63	32	36	30	C-GR20/16SX	C-GR20/16ZS	C-GR20/16S
		25	16	46	25,5	68	41	46	30	C-GR25/16SX	C-GR27/16ZS	C-GR27/16S
		25	20	48	25,5	71	41	46	36	C-GR25/20SX	C-GR25/20ZS	C-GR25/20S
		30	20	50	26	74	46	50	36	C-GR30/20SX	C-GR30/20ZS	C-GR30/20S
30		25	52	26,5	77	46	50	46	C-GR30/25SX	C-GR30/25ZS	C-GR30/25S	
38		30	59	29,5	87	55	60	50	C-GR38/30SX	C-GR38/30ZS	C-GR38/30S	

Illustrations non-binding

Design, dimensional and material changes reserved

Pneumatics / Fittings and couplings / Tube fittings / Tube fittings - Zinc plated steel ISO 8434-1 (DIN 2353) / Straight reducing fitting Series C-GR

Version 6

138462 / Generated 2026/24 EN

MADE IN EUROPE

+43 512 52076

austria@stasto.eu

© STASTO Automation KG

www.stasto.com

Open series online

Page 2 / 2

